

- **Dismantles completely**
- **Replacement cutter tube available in three diameters 3,5, 4.2 and 5.5mm**
- **High suction, based on a optimal suction chanel**
- **Tip rotates 360° in 45° steps**
- **Ideal in the meniscus front area**

- High quality hand held instruments
- Integrated overload release mechanism to minimize tip breakage
- Ergonomic design
- Precise cut
- Lifetime material warranty

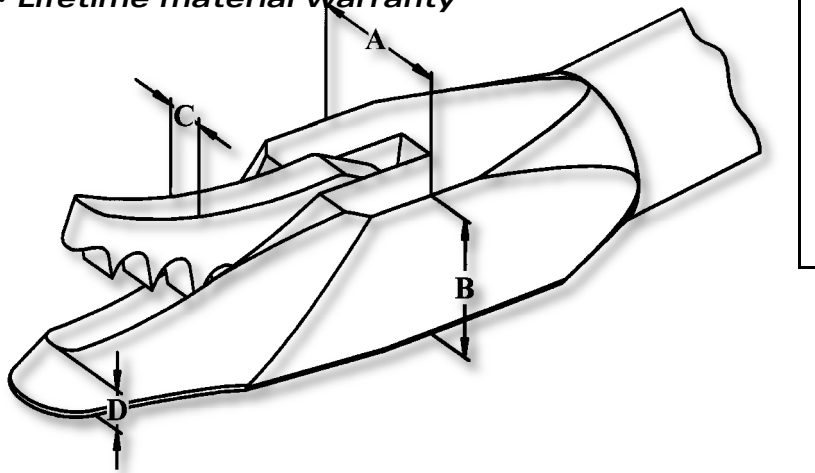

- Closed Shaft with Teflon
- Various designs available
- High performance

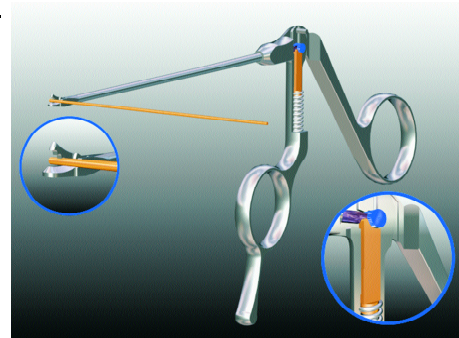

normal

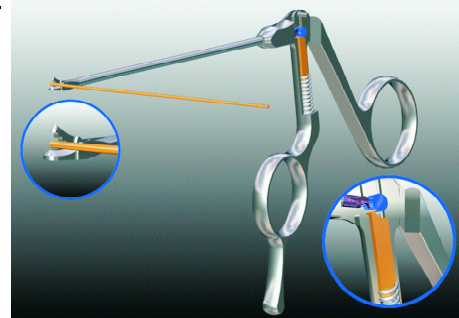

overloaded



Cat. No. 731230  
B = 3,4 mm  
C = 3,2 mm

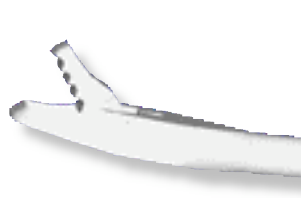

Cat. No. 731231  
B = 3,4 mm  
C = 3,2 mm



Cat. No. 731232  
B = 3,4 mm  
C = 3,2 mm



Cat. No. 731233  
B = 3,4 mm  
C = 3,2 mm



Cat. No. 731220  
B = 3,4 mm  
C = 2,0 mm

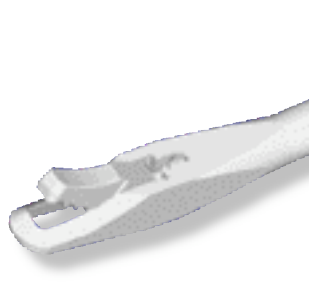

Cat. No. 731221  
B = 3,4 mm  
C = 2,0 mm



Cat. No. 731224  
B = 3,4 mm  
C = 2,0 mm



Cat. No. 731226  
B = 3,4 mm  
C = 2,0 mm

- 3.4 mm diameter closed shaft
- Smooth tip design
- 8° up Tip for optimal positioning

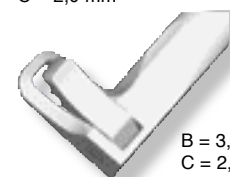

B = 3,4 mm  
C = 2,0 mm

Cat. No. 731228 90° right  
Cat. No. 731229 90° left

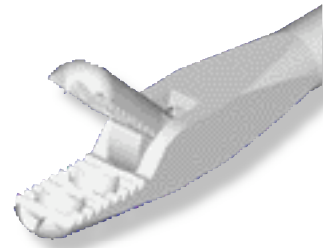

Cat. No. 731250  
B = 3,4 mm  
C = 3,4 mm

- **High quality graspers**
- **Integrated overload release mechanism to minimize tip breakage**
- **Internal fixation, designed for one hand**
- **3.4 mm diameter closed shaft**
- **Perfect grip**



Cat. No. 731251  
B = 3,4 mm  
C = 3,4 mm



Cat. No. 731100  
B = 2,75 mm  
C = 0,8 mm

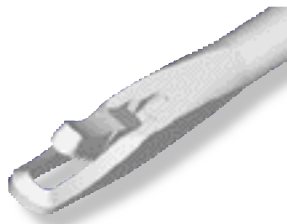

Cat. No. 731110  
B = 2,75 mm  
C = 1,4 mm



Cat. No. 731102  
B = 2,75 mm  
C = 0,8 mm

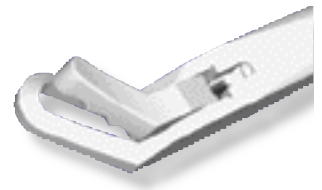

Cat. No. 731114  
B = 2,75 mm  
C = 1,4 mm



Cat. No. 731130  
B = 2,75 mm  
C = 3,5 mm



Cat. No. 731131  
B = 2,75 mm  
C = 3,5 mm



Cat. No. 731103  
B = 2,75 mm  
C = 0,8 mm

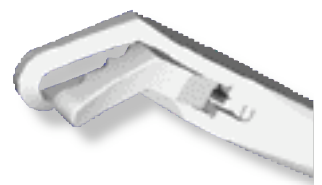

Cat. No. 731115  
B = 2,75 mm  
C = 1,4 mm

- **2.75 mm diameter closed shaft**
- **Smooth tip design**
- **8° up Tip for optimal positioning**

- High quality hand held instruments
- Integrated overload release mechanism to minimize tip breakage
- Ergonomic design
- Precise cut
- Lifetime material warranty

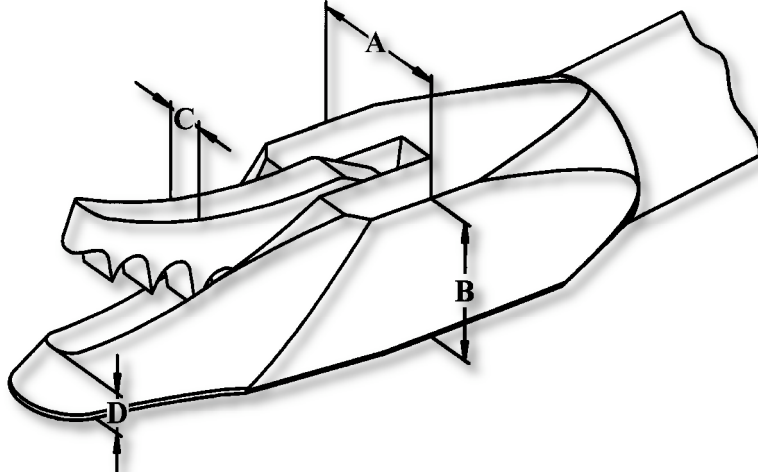

- Open Shaft-System with Teflon
- Various designs available
- High performance

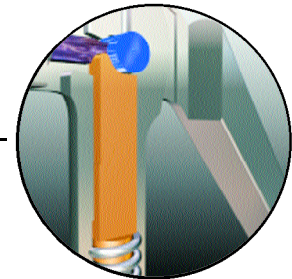

normal

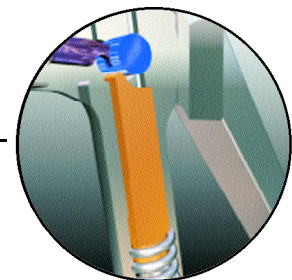

overloaded



Cat. No. 751230  
B = 3,4 mm  
C = 3,2 mm



Cat. No. 751231  
B = 3,4 mm  
C = 3,2 mm



Cat. No. 751232  
B = 3,4 mm  
C = 3,2 mm

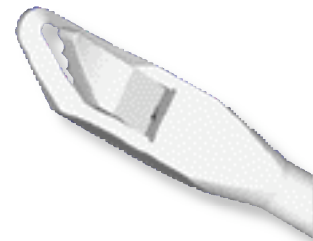

Cat. No. 751233  
B = 3,4 mm  
C = 3,2 mm

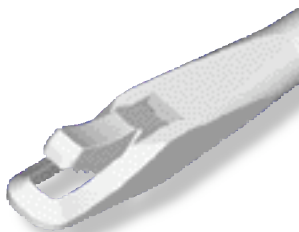

Cat. No. 751220  
B = 3,4 mm  
C = 2,0 mm



Cat. No. 751221  
B = 3,4 mm  
C = 2,0 mm



Cat. No. 751224  
B = 3,4 mm  
C = 2,0 mm

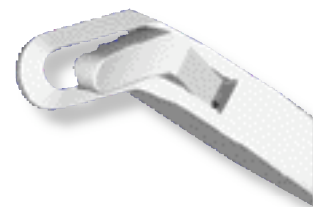

Cat. No. 751225  
B = 3,4 mm  
C = 2,0 mm

- 3.4 mm diameter open shaft
- Smooth tip design
- 8° up Tip for optimal positioning

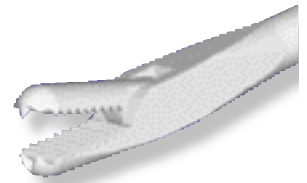

Cat. No. 751250  
B = 3,4 mm  
C = 3,4 mm

- **High quality graspers**
- **Integrated overload release mechanism to minimize tip breakage**
- **Internal fixation, designed for one hand**
- **3.4 mm diameter open shaft**
- **Perfect grip**

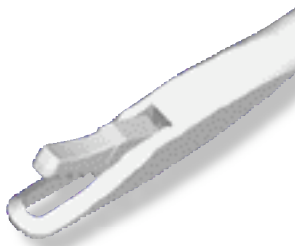

Cat. No. 751110  
B = 2,75 mm  
C = 1,4 mm



Cat. No. 751111  
B = 2,75 mm  
C = 1,4 mm

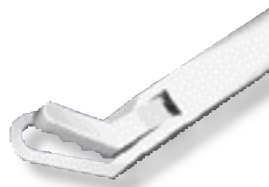

Cat. No. 751114  
B = 2,75 mm  
C = 1,4 mm



Cat. No. 751115  
B = 2,75 mm  
C = 1,4 mm



Cat. No. 751130  
B = 2,75 mm  
C = 3,5 mm



Cat. No. 751131  
B = 2,75 mm  
C = 3,5 mm



Cat. No. 751132  
B = 2,75 mm  
C = 3,5 mm



Cat. No. 751133  
B = 2,75 mm  
C = 3,5 mm

- **2.75 mm diameter open shaft**
- **Smooth tip design**
- **8° up Tip for optimal positioning**